



Interactive Collection.

PRODUCT CATALOG 2020

OUTFORM[™]

©2020 OUTFORM[™] ALL RIGHTS RESERVED.

VOICE EXPERIENCE



REPLACE CROWDED AND CONFUSING BUTTONS WITH SIMPLE VOICE COMMANDS

As shoppers become more accustomed to voice commands in everyday life, this experience seamlessly integrates voice commands into the retail environment. The Voice Experience replaces touch interaction with wake words, and commands that allow shoppers to verbally engage with the display, even when offline. The offline voice experience can be programmed to host pre-recorded commands like “play the video,” or “turn up the volume,” to deliver a defined story, according to the shoppers’ needs.





VOICE EXPERIENCE

SECURED OFFLINE SOLUTION

Internet connectivity can be a challenge in the retail space. To that end, we developed the offline voice solution to deliver a pre-recorded experience that does not require internet connection.

WE RECOMMEND

Combine the Voice Experience with the Light Controller Module to create the ultimate dynamic retail experience.

MODULAR

Periodic updates are key in keeping shoppers engaged and excited about your product. For this reason, we designed the Voice Experience to be adaptable to simple upgrades and experience developments.

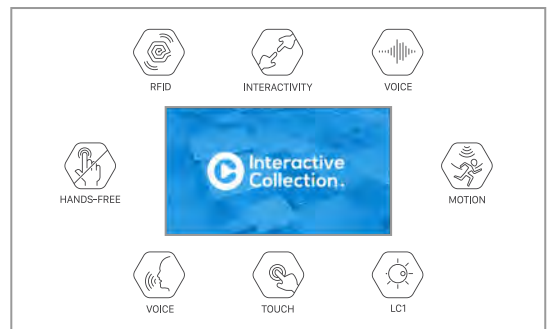
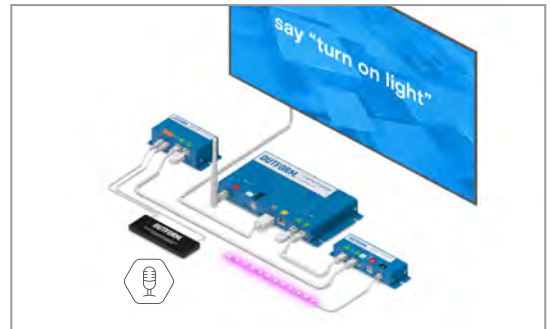
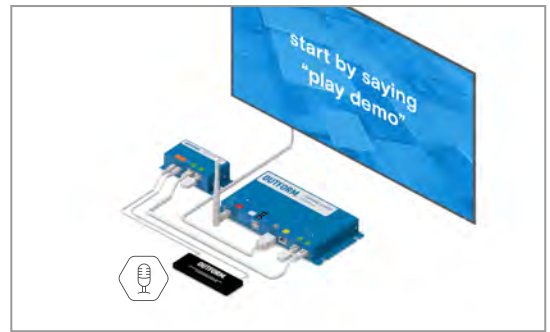

INTERACTIVITY

By combining this experience with different sensors and triggers, this experience can support a combination of user interactions such as touch, voice, motion, and many more.



VOICE CAPTURE

Advanced offline speech processing to deliver optimal retail experiences.



HANDS-FREE

The voice experience gives shoppers the opportunity to learn about products without the need to touch the display surface.



OIE

Outform Interactive Editor gives you the tools to create your own experiences with ease using Control Center configuration



PRODUCT SIZE

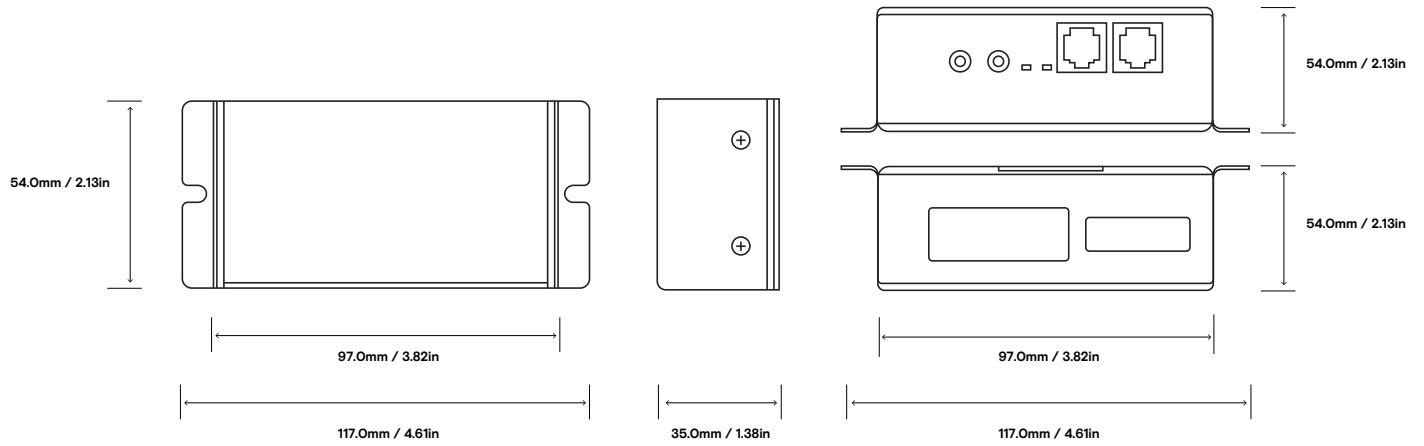

RECOGNITION METHOD	OFFLINE
NUMBER OF OFFLINE RECOGNIZED PHRASES	UP TO 40
PHRASE UPDATE METHOD	SOFTWARE
MICROPHONE QUANTITY	2
RECOMMENDED DISTANCE BETWEEN MICROPHONES	100mm
MICROPHONE TYPE	CONDENSOR MICROPHONE
ODC POWER	VOLTAGE RANGE: DC 10-20V MAX UNIT POWER CONSUMPTION: 12W
ODC POWER	ODC DATA LINES: IEC 61000-4-2, LEVEL 4 MICROPHONE INPUT: MIL-STD-883 METHOD 3015.7



FAQ

HOW CAN VOICE COMMANDS BE CHANGED?

Contact us on the technical support page to make voice command edit requests. We will validate the request and reply with a file to program the device.

HOW MANY COMMANDS CAN RUN ON THE VOICE EXPERIENCE?

The Voice Experience was designed to support up to 40 commands.

HOW DO I AVOID FALSE COMMANDS?

Make sure your display does not include keywords which activate the voice commands.



VOICE CONTROLLER

UIC5001-01

To facilitate the Voice Experience, the voice command controller captures voice commands, and triggers on-screen responses.

[Click here](#) to watch the system build tutorial.

[Click here](#) to watch the OIE build tutorial.

