



# Interactive Collection.

PRODUCT CATALOG 2020

**OUTFORM**<sup>™</sup>

©2020 OUTFORM<sup>™</sup> All RIGHTS RESERVED.



## THE INTERACTIVE COLLECTION

The Interactive Collection gives integrators, display builders, retailers, and brands the creative tools and building blocks needed to bring leading retail innovation to life. Catering to the specific needs of the modern day shopper, retailers can develop bespoke solutions with systems as simple as plug and play, or drag and drop.

Outform's Interactive Editor is a software that can be thought of like a foundation, and the Standard Modules like building blocks. The main standard module, or the Control Center acts like a brain, connecting the different Standard Modules needed to create the experience. By dragging and dropping the desired retail display functions into the Interactive Editor, a custom interaction is created which can be downloaded to a USB and connected to the Control Center.

No matter the pairing between Standard Modules, the Interactive Collection will deliver seamless, and customized experiences. The unique configurations that can be created will engage the shopper and open the door for further product discovery. By adapting to the new normal of retail, the Interactive Collection accommodates several opportunities for hands-free product discovery. The Interactive Collection is exciting, encourages play and curiosity, and couples technology with retail experiences that shoppers now demand.

# VOICE EXPERIENCE



## REPLACE CROWDED AND CONFUSING BUTTONS WITH SIMPLE VOICE COMMANDS

As shoppers become more accustomed to voice commands in everyday life, this experience seamlessly integrates voice commands into the retail environment. The Voice Experience replaces touch interaction with customizable wake words, and commands that allow shoppers to verbally engage with the display, even when offline. The offline voice experience can be programmed to host custom pre-recorded commands like “play the video,” or “turn up the volume,” to deliver a defined story, according to the shoppers’ needs.





# VOICE EXPERIENCE

## CUSTOMIZED COMMANDS

Personalized to highlight your brand, the Voice Experience can be tailored to support any custom wake word (i.e.: “Hey [product name]”, “Hi [brand name]” etc.). Additionally, the experience can support up to 40 custom commands like “play the video.”

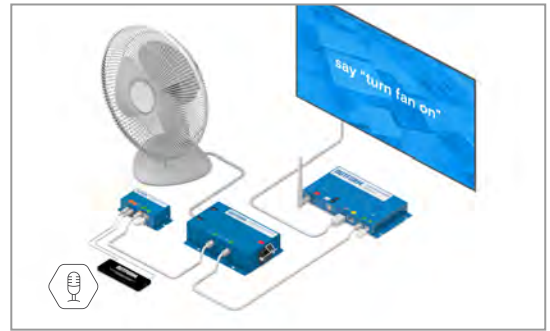

## SECURED OFFLINE SOLUTION

Internet connectivity can be a challenge in the retail space. To that end, we developed the offline voice solution to deliver a pre-recorded experience that does not require internet connection.

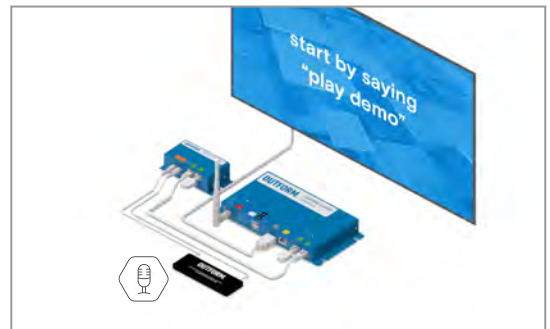

## WE RECOMMEND

Combine the Voice Experience with the Light Controller Module to create the ultimate dynamic retail experience.

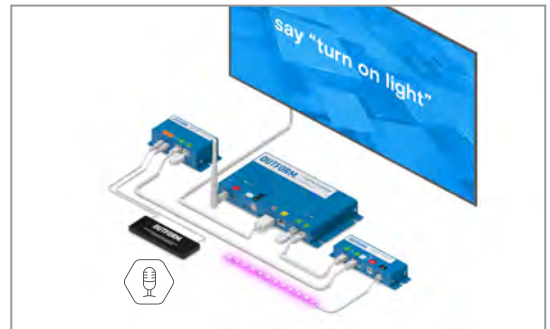

## MODULAR

Periodic updates are key in keeping shoppers engaged and excited about your product. For this reason, we designed the Voice Experience to be adaptable to simple upgrades and experience developments.

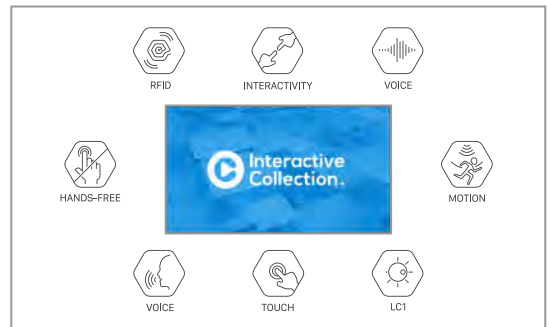

### INTERACTIVITY

By combining this experience with different sensors and triggers, this experience can support a combination of user interactions such as touch, voice, motion, and many more.



### VOICE CAPTURE

Advanced offline speech processing to deliver optimal retail experiences.



### HANDS-FREE

The voice experience gives shoppers the opportunity to learn about products without the need to touch the display surface.



### OIE

Outform Interactive Editor gives you the tools to create your own experiences with ease using Control Center configuration



## PRODUCT SIZE

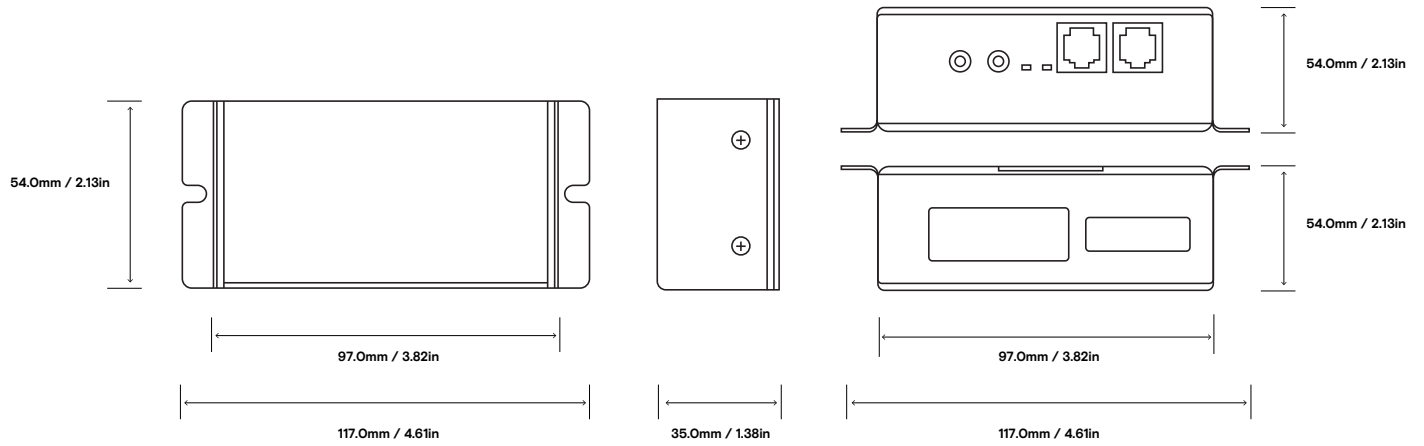

<b>RECOGNITION METHOD</b>	OFFLINE
<b>NUMBER OF OFFLINE RECOGNIZED PHRASES</b>	UP TO 40
<b>PHRASE UPDATE METHOD</b>	SOFTWARE
<b>MICROPHONE QUANTITY</b>	2
<b>RECOMMENDED DISTANCE BETWEEN MICROPHONES</b>	100mm
<b>MICROPHONE TYPE</b>	CONDENSOR MICROPHONE
<b>ODC POWER</b>	VOLTAGE RANGE: DC 10-20V MAX UNIT POWER CONSUMPTION: 12W
<b>ODC POWER</b>	ODC DATA LINES: IEC 61000-4-2, LEVEL 4 MICROPHONE INPUT: MIL-STD-883 METHOD 3015.7



## FAQ

### **HOW CAN VOICE COMMANDS BE CHANGED?**

Contact us [Here](#) to make voice command edit requests. We will validate the request and reply with a file to program the device.

### **HOW MANY COMMANDS CAN RUN ON THE VOICE EXPERIENCE?**

The Voice Experience was designed to support up to 40 commands.

### **CAN I CUSTOMIZE MY OWN WAKE WORD?**

Yes- the Voice Experience supports a full customization of wake words.

### **HOW DO I AVOID FALSE COMMANDS?**

Make sure your display does not include keywords which activate the voice commands.



## VOICE CONTROLLER

To facilitate the voice experience, the voice command controller captures voice commands, and triggers on-screen responses.

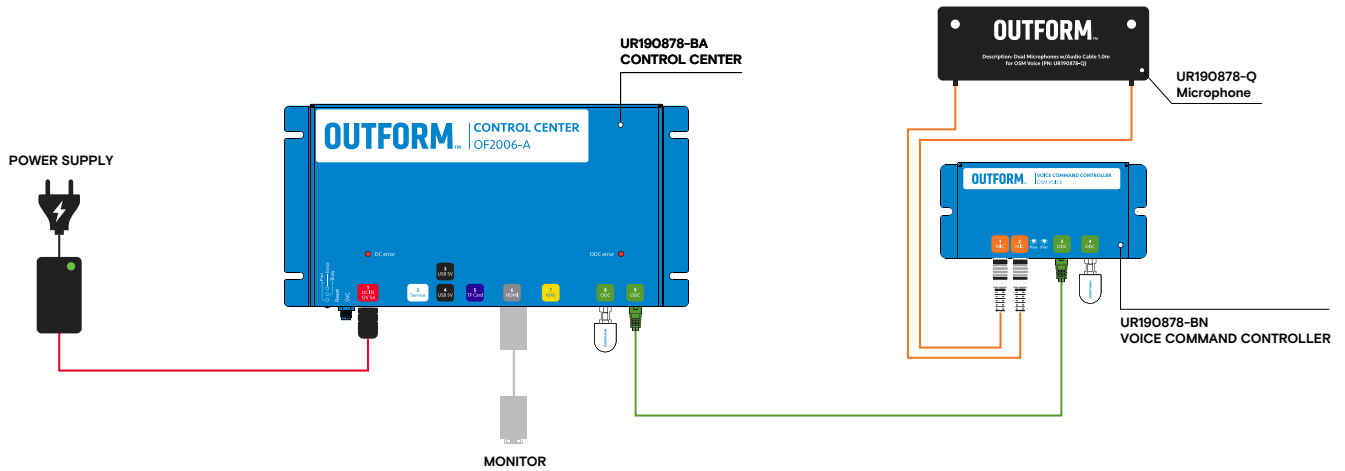

## VOICE CONTROLLER + RGB CONTROLLER + POWER SWITCH

This exciting kit is used to build a dynamic experience that captures voice commands, to create unlimited color combinations, and save energy by powering on and off. By adding lights to this experience, retailers can wow shoppers by highlighting specific products at users' requests.

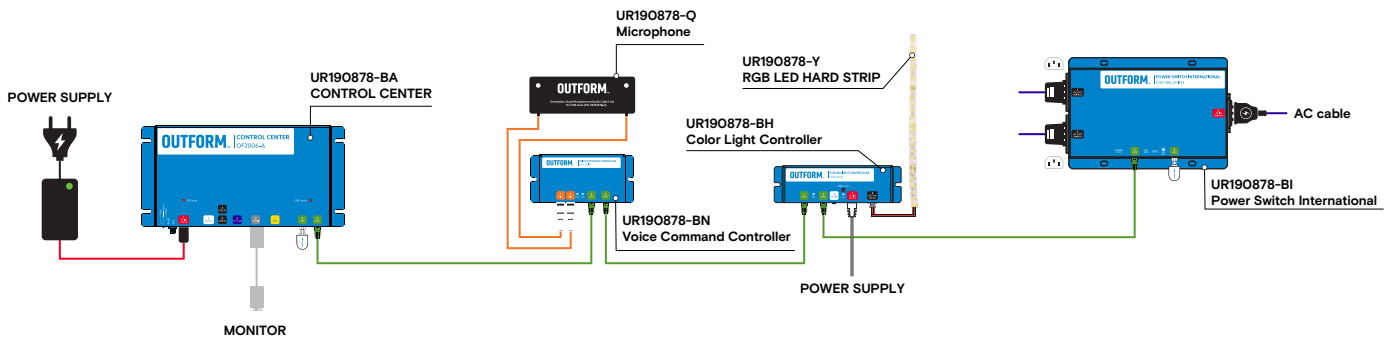

- AC CABLE
- 12V DC CABLE
- ODC RJ25 CABLE
- AUDIO CABLE
- USB CABLE
- HDMI CABLE
- GPIO CABLE
- RFID CABLE